

DURASPAN 35mm COST EFFECTIVE TEMPORARY AND PERMANENT PARTITION SYSTEM.
500mm wide x 35mm thick EXTRUDED, RECYCLED PVC PANEL
PARTITIONS CAN GO FROM 1m UP TO 6m high DEPENDANT ON FIXINGS.

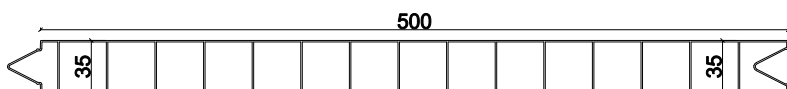

DURASPAN WP1963 500 X 35mm 1:5

DURASPAN 35mm BOARD VERTICAL INTERLOCKING SYSTEM, WITH 500mm WIDE BOARDS.

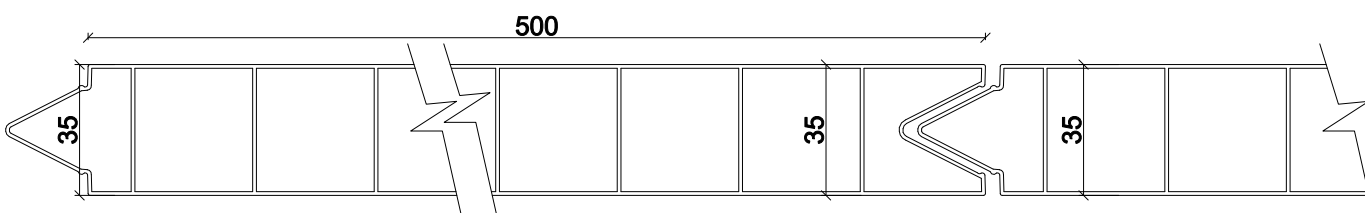

DURASPAN 1:2

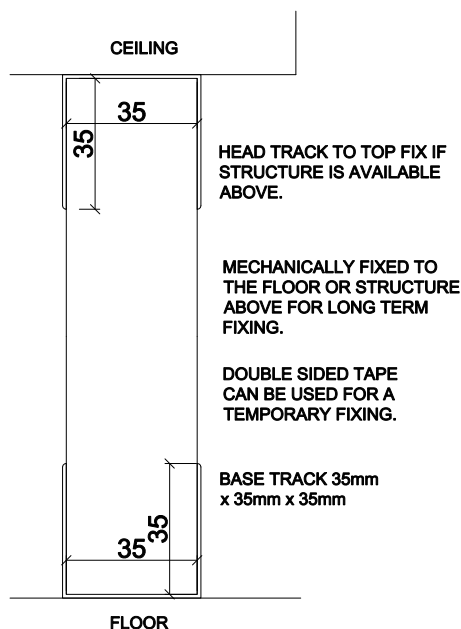

TRACKS 1:2

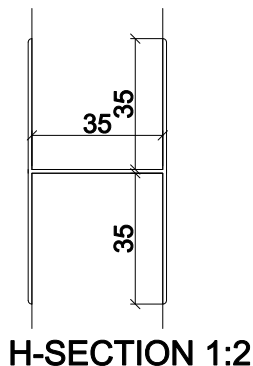

H-SECTION 1:2

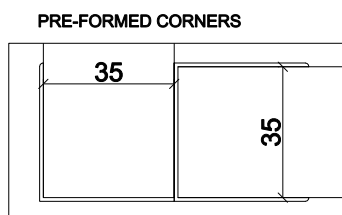

CORNER1:2

FLEXI ANGLE FOR INTERNAL AND EXTERNAL CORNERS NOT AT RIGHT ANGLES. THE FLEXI ANGLE CAN ALSO BE USED FOR WINDOW REVEALS.

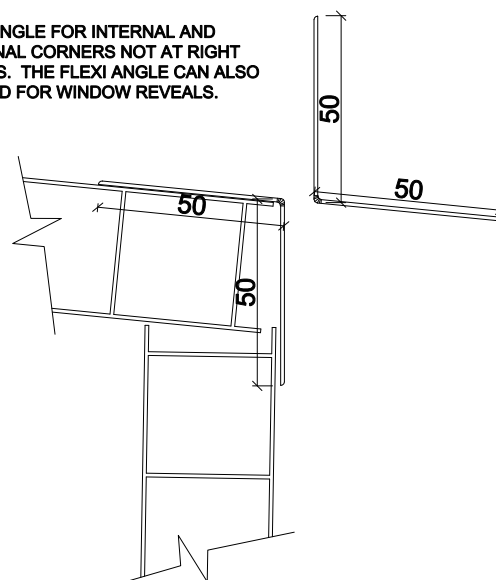

FLEXI ANGLE 1:2

NOTES

DURASPAN IS AN EXTRUDED 35mm BOARD - 4.4kg/m. THE UV VALUES FOR THIS PRODUCT BASED ON THE FORMULA OF THIS PVC COMPOUND HAVE A GOOD WEATHERING PERFORMANCE. THIS PRODUCT IS MADE FROM 100% RECYCLED OLD WINDOW FRAMES, WHICH PROVIDES A COST EFFECTIVE PARTITIONING SYSTEM; IT CAN BE USED FOR PERMANENT FACTORY PARTITIONS AS A LOWER COST ALTERNATIVE TO OTHER SYSTEMS.

CLEANING STRATEGY FOR O&M MANUALS SEE CSO&M DATA SHEET.

NBS Ref: K30/112